

DESCRIPTION

New design concept of single-arm wall bracket, created to be installed on the wall during the insulation of the building under construction (integration with thermal insulation).

It can be used on any type of coat currently on the market.

Use of a single horizontal arm capable of supporting the weight of machines used in domestic heating and cooling.

Adjustable sliding bar to get two different measures, deriving by the distance from the wall of the support brackets. This distance changes according to the thickness of the thermal coat, as well as the weight of the unit, which causes a variation in bending of the support.

GENERAL CHARACTERISTICS

Pre-galvanised structural steel (S designation) with optimal values of yield and tensile strength protected by polyester powder painting RAL9002, average thickness 100µm, salt spray resistance tested up to a duration of application equal to 500 hours.

Load capacity equal to 110 kg evenly distributed over the brackets.

Fixing of the machine on anti-vibration dampers to reduce the vibrations.

Self-locking M8 nuts and screws made of carbon steel with white galvanization to insure the fixation along the years even after thermal changes and continuous vibrations.

The system total weight is 6.60kg.

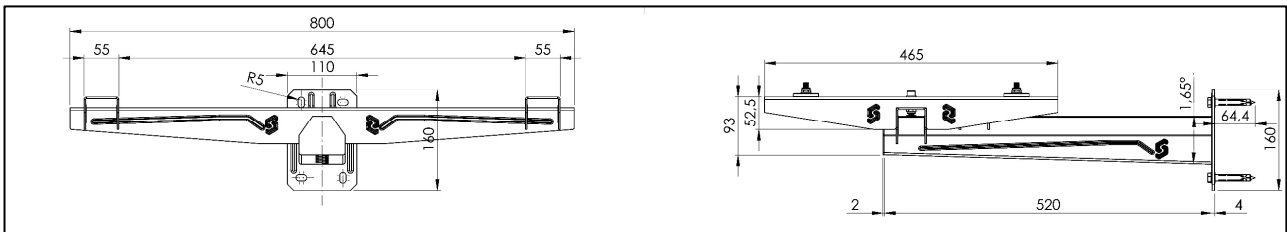
DIMENSIONAL CHARACTERISTICS

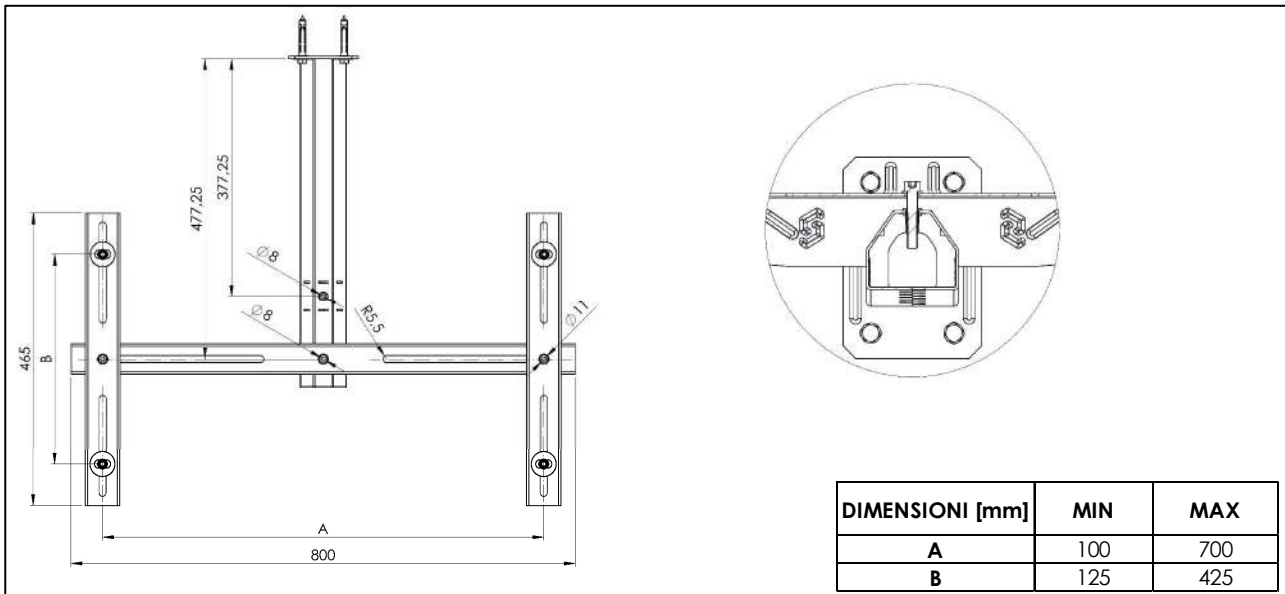

SUPPLY COMPOSITION

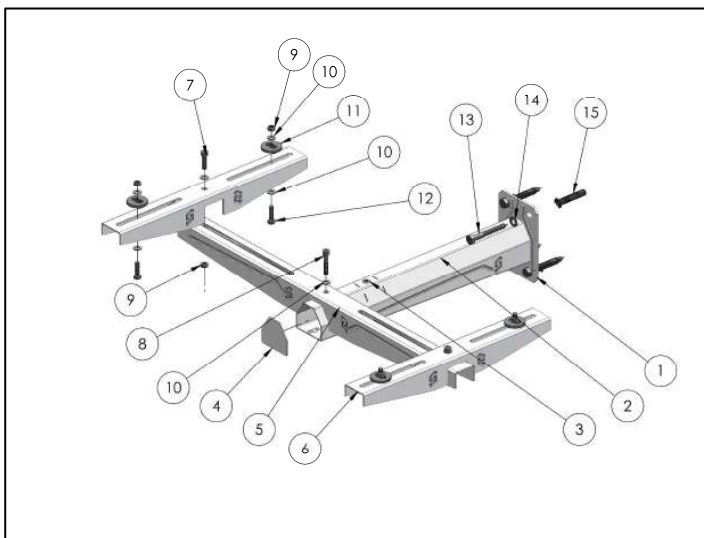

Article Number	Description	Quantity
1	Base plate 110x160 mm	1
2	Central support 520x76,5 mm	1
3	Galvanized threaded insert M8x18,5 mm	2
4	Welded end cap	1
5	Adjustable sliding bar 800x57,5x48 mm	1
6	Adjustable support arm 465x52,5x55 mm	2
7	Socket head cap screw CL. 4.8 M8x30	2
8	Socket head cap screw CL. 4.8 M8x45	1
9	Self-blocking hex head nut with nylon insert Z.B. M8	6
10	Flat Washer 8,4x16x1,6 mm	4
11	TPE Antivibration damper	15
12	TE Z.B. fully threaded screw CL. 4.8 M10x90 mm	4
13	Wood hex head screw TE Z.B. CL.4.8 M10x90 mm	4
14	Flat Washer 10,5x20x2 mm	4
15	Nylon wall plug Shark PRO 12x66 mm	4

WALL SYSTEM FIXING

The wall fixing of the base plate has to be done with hexagonal head wood screws DIN 571 Z.B. CL 4.8 and plugs type Shark PRO. The hole has to be done on masonry with a 12 mm point/tip and a 75 mm depth. We advise you to follow the producer indications (that you can see below) for a correct installation.



Maximum charge recommended in kN and conditions of installation:						
Ø Plug	5	6	8	10	12	14
Concrete C20/C25	0,5	0,9	1,1	1,9	2,4	2,8
Solid brick	0,3	0,5	0,7	1,4	1,7	1,7
Preforated brick	0,1	0,2	0,2	0,3	0,3	0,4
Cellular concrete (YTONG)	0,05	0,1	0,1	0,15	0,2	0,35
Plasterboard thickness 12,5 mm	0,1	0,1	0,1	0,1	0,1	0,1
Plasterboard thickness 25 mm	0,15	0,15	0,15	0,15	0,15	0,15
Cellulose fiber gypsum boards (Fermacell)	0,2	0,2	0,2	0,25	0,25	0,25
Ø Drilling [mm]	5	6	8	10	12	14
Minimum depth for the drilling [mm]	40	45	55	65	75	85
Minimum distance to the edge [mm]	30	35	40	50	65	80
Minimum screw length [mm]	Plug length + Ø Plug + Thickness object to fix					