



Model: NE2130Z
Code: 262DA50

embraco POWER IN.
CHANGE ON

Type:	On-off
Voltage [V] / Frequency [Hz] / Phases	220-240 V 50 Hz 1 ~
Refrigerant:	R-134a
Application:	LBP

Motor type:	CSIR
Starting torque:	HST
HP:	1/3
Displacement:	12.11 cm ³

OPERATING CONDITION : ASHRAE LBP 32

Evaporation Temp.	-23.3 °C	Return Temp.	32.2 °C	Superheating	55.5 K
Condensing Temp.	54.4 °C	Liquid Temp.	32.2 °C	Subcooling	22.2 K

Cooling capacity	Power consumption	Mass flow rate	Efficiency
348.79 W	259.14 W	6.77 kg/h	1.35 W/W

APPLICATION

Evaporating temperature range:	-30 to -5 °C	Cooling type:	Fan Cooling
Permanent operating temperature (peak) :	60 (70) °C	Air Flow	--
Expansion device:	Capillary tube or Expansion valve	Maximum motor temperature:	130 °C

ELECTRICAL DATA

Start winding resistance at 25°C (77°F):	31.85 Ω +/- 8%	Run winding resistance at 25°C (77°F):	6.25 Ω +/- 8%
FLA - full load amperage L/MBP [A] 50 Hz / 60 Hz:	- / -	LRA (A) 50 Hz / 60 Hz:	- / -
		FLA - full load amperage HBP [A] 50 Hz / 60 Hz:	- / -

MECHANICAL DATA

Bore:	27.78 mm	Stroke:	10 mm
		Displacement:	12.11 cm ³

OTHER INFORMATION

Weight:	10.95 kg	Oil charge:	350 ml
Lubricant type:	Polyolester ISO22	Nitrogen charge:	Yes

EXTERNAL SETTINGS

	Shape	Material	Diameter [mm]
Suction connector	Slanted 42°	Copper	8.10
Discharge connector	Straight	Copper	6.10
Process connector	Slanted 42°	Copper	6.10
Base plate:	European Standard	Tray holder:	No

PERFORMANCES AT STANDARD CHECK-POINTS

Checkpoint	Cooling capacity	Power consumption	Gas flow rate	Cooling Efficiency	Heating capacity +/-	Heating Efficiency
	+/-5% W	+/-5% W	+/-5% kg/h	+/- 7% W/W	5%* W	+/- 7% W/W
ARI LBP	292.26	276.43	7.68	1.06	414.86	1.50
ARI MBP	641.35	436.64	17.19	1.47	823.60	1.89
ASHRAE CBP	686.51	403.19	14.95	1.70	882.79	2.19
ASHRAE LBP 32	348.79	259.14	6.77	1.35	476.43	1.84
CECOMAF LBP	258.06	246.89	6.15	1.05	378.92	1.53
EN12900 MBP**	615.32	356.07	13.44	1.73	780.83	2.19

* Calculations performed considering isentropic compression and a housing loss of 10%. This is an estimated heat amount discarded in the discharge pipe and the condenser combined.

CONDENSING TEMP. 35 °C**(SUBCOOLING : 22.2 K, RETURN TEMP.: 32 °C)**

Evaporating temperature °C	Cooling capacity	Power consumption	Gas flow rate	Cooling Efficiency	Heating capacity +/-	Heating Efficiency
	+/-5%	+/-5%	+/-5%	+/- 7%	5% *	+/- 7%
	W	W	kg/h	W/W	W	W/W
-30.00	306.39	205.29	5.17	1.49	397.02	1.93
-25.00	398.81	232.67	6.74	1.71	503.65	2.16
-20.00	511.81	263.25	8.67	1.94	630.64	2.40
-15.00	648.64	296.45	11.01	2.19	780.62	2.63
-10.00	812.62	331.26	13.84	2.45	956.15	2.89
-5.00	1,007.39	366.13	17.22	2.75	1,159.99	3.17

CONDENSING TEMP. 45 °C**(SUBCOOLING : 22.2 K, RETURN TEMP.: 32 °C)**

Evaporating temperature °C	Cooling capacity	Power consumption	Gas flow rate	Cooling Efficiency	Heating capacity +/-	Heating Efficiency
	+/-5%	+/-5%	+/-5%	+/- 7%	5% *	+/- 7%
	W	W	kg/h	W/W	W	W/W
-30.00	272.76	210.65	4.92	1.29	369.72	1.76
-25.00	357.90	241.48	6.47	1.48	472.22	1.96
-20.00	461.19	276.10	8.36	1.67	592.94	2.15
-15.00	586.32	314.50	10.66	1.86	735.35	2.34
-10.00	736.72	356.07	13.44	2.07	902.23	2.53
-5.00	915.86	399.74	16.77	2.29	1,096.29	2.74

CONDENSING TEMP. 55 °C**(SUBCOOLING : 22.2 K, RETURN TEMP.: 32 °C)**

Evaporating temperature °C	Cooling capacity	Power consumption	Gas flow rate	Cooling Efficiency	Heating capacity +/-	Heating Efficiency
	+/-5%	+/-5%	+/-5%	+/- 7%	5% *	+/- 7%
	W	W	kg/h	W/W	W	W/W
-30.00	235.04	211.61	4.57	1.11	334.41	1.58
-25.00	315.63	246.89	6.15	1.28	436.50	1.77
-20.00	410.25	285.46	8.02	1.44	552.08	1.93
-15.00	523.83	328.28	10.27	1.60	686.71	2.09
-10.00	660.29	375.37	12.99	1.76	844.08	2.25
-5.00	823.17	426.07	16.26	1.93	1,027.13	2.41

ELECTRICAL ACCESSORIES

Kit:	1
Starter device:	CURRENT RELAY
Engineering code:	MTRP-0027
Run capacitor:	--
Starting capacitor:	43-53

Thermal protector: T0156/G5**Institutes approved for this electric kit:**

If purchased without electricals consult Embraco to verify the supplier of electricals approved for this compressor

MECHANICAL ACCESSORIES**Rubber damper:** Yes**Metal bushing:** Optional

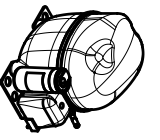

SCALE 1:10

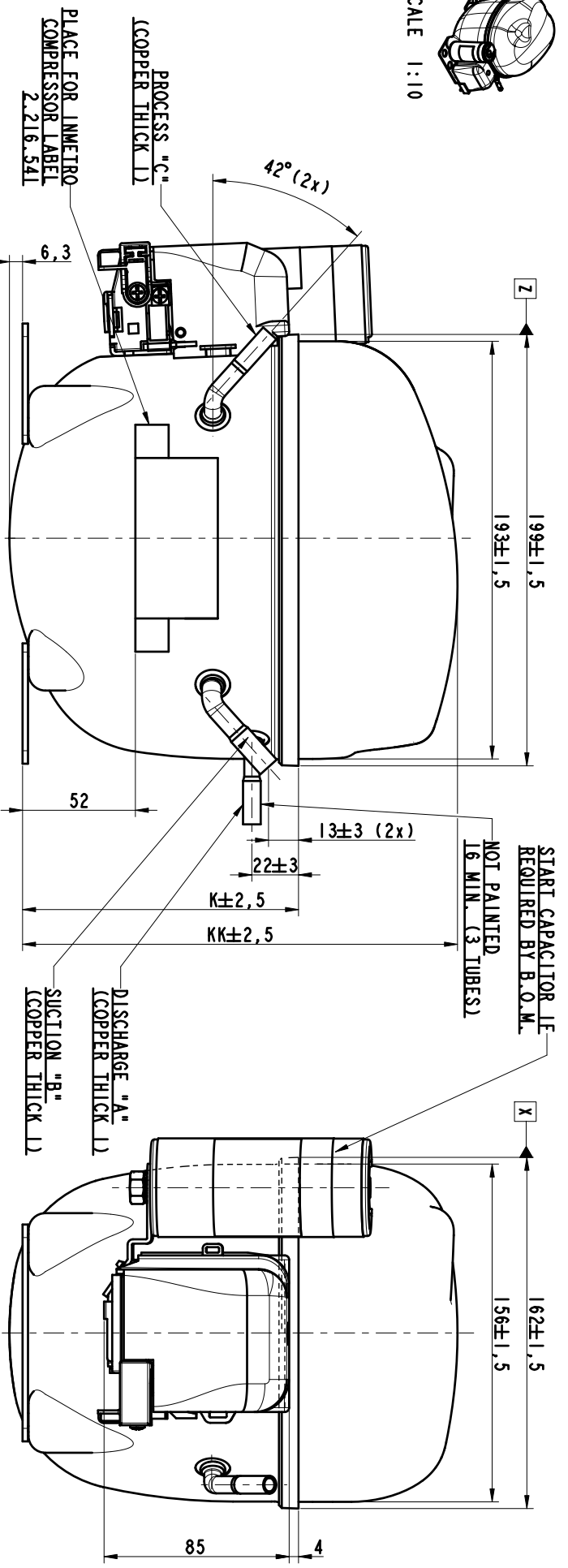

Ø 16^{+0,25} (6 HOLES)

≡ 3 Z
 ≤ 1,5 X

50HZ MODELS

ECM	REVISION	LO	BY	APP	DATE
39503	3	TAB	KK	RR	07.09.2015
44703	4	TAB	KK	NG	20.01.2017

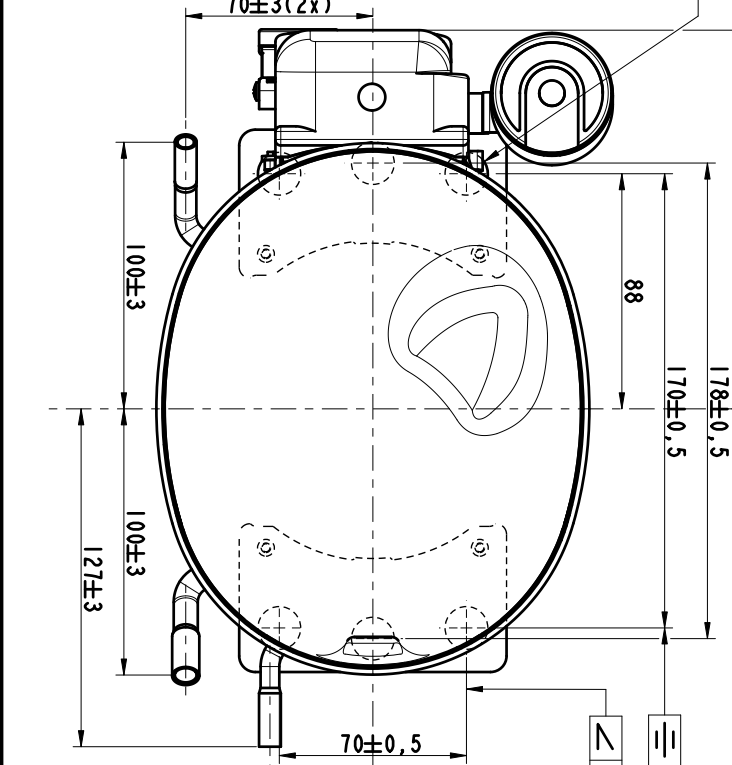

CODE :	MATERIAL :
APP. : VALENO P.	NAME
ECM : TDT 29225	embraco
	VISTA ESTERNA "NE"
	EXTERNAL VIEW "NE-COMPRESSORS"
	GEN. TOL. : --
	ANG. TOL. : --
	SCALE : 1:2
	REPLACE : --
	No. : 1.960.798

206	127	188	115	200	127	188	115	206	127	188	115	200	127	188	115	206	127	188	115				
1	1	1	1	1	1	1	1	1	1	1	1	1	1	1	1	1	1	1	1	1			
6.1-6.2	8.1-8.2	6.1-6.2	8.1-8.2	6.1-6.2	8.1-8.2	6.1-6.2	8.1-8.2	6.1-6.2	8.1-8.2	6.1-6.2	8.1-8.2	6.1-6.2	8.1-8.2	6.1-6.2	8.1-8.2	6.1-6.2	8.1-8.2	6.1-6.2	8.1-8.2	6.1-6.2	8.1-8.2		
X 20 DEEP	X 20 DEEP	X 20 DEEP	X 20 DEEP	X 20 DEEP	X 20 DEEP	X 20 DEEP	X 20 DEEP	X 20 DEEP	X 20 DEEP	X 20 DEEP	X 20 DEEP	X 20 DEEP	X 20 DEEP	X 20 DEEP	X 20 DEEP	X 20 DEEP	X 20 DEEP	X 20 DEEP	X 20 DEEP	X 20 DEEP	X 20 DEEP	X 20 DEEP	
953.51	952.51	261.50	261.51	952.51	952.51	261.50	261.51	952.51	952.51	261.50	261.51	952.51	952.51	261.50	261.51	952.51	952.51	261.50	261.51	952.51	952.51	261.50	261.51
NE21346K	NE61816K	NE5160Z	NE6160Z	NE5170Z	NE6170Z	NE5187Z	NE6187Z	NE2125E	NE6210E	NE2125GK	NE6210GK	NE5160Z	NE6160Z	NE5170Z	NE6170Z	NE5187Z	NE6187Z	NE2125E	NE6210E	NE2125GK	NE6210GK	NE5160Z	NE6160Z



SCALE 1:10

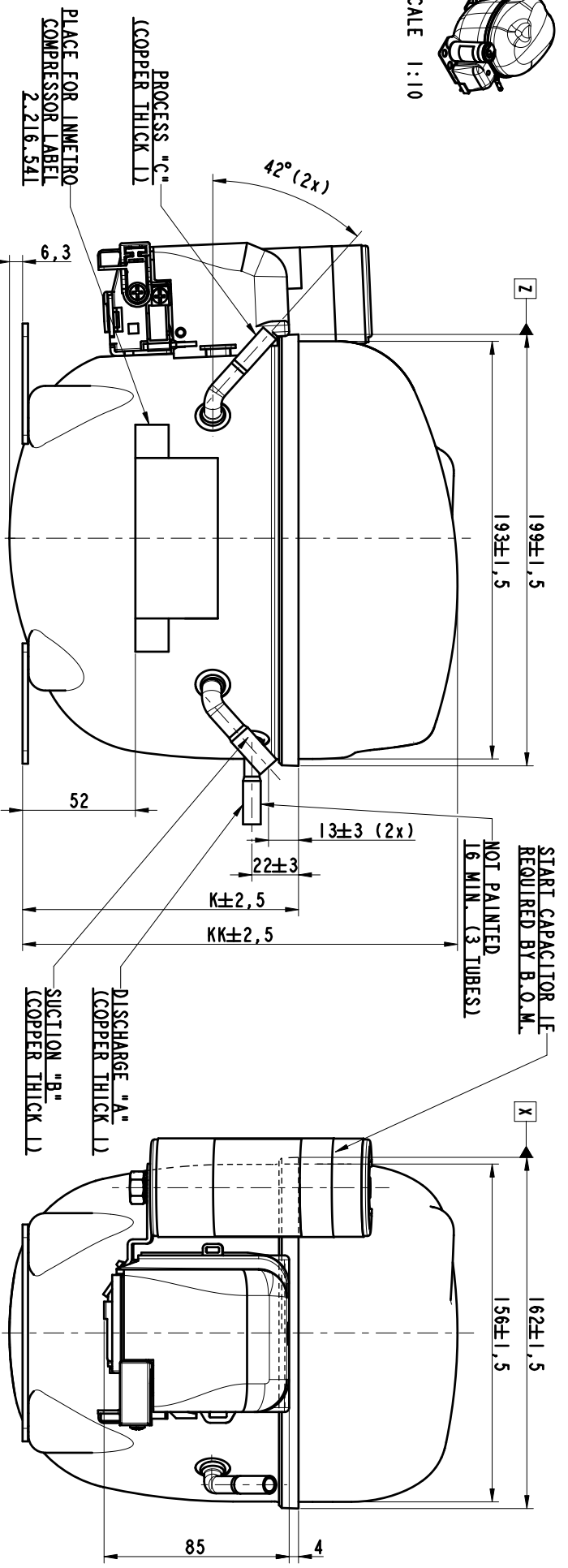

Ø 16^{+0,25} (6 HOLES)

≡ 3 Z
 ≤ 1,5 X

50HZ MODELS

ECM	REVISION	LO	BY	APP	DATE
39503	3	TAB	KK	RR	07.09.2015
44703	4	TAB	KK	NG	20.01.2017

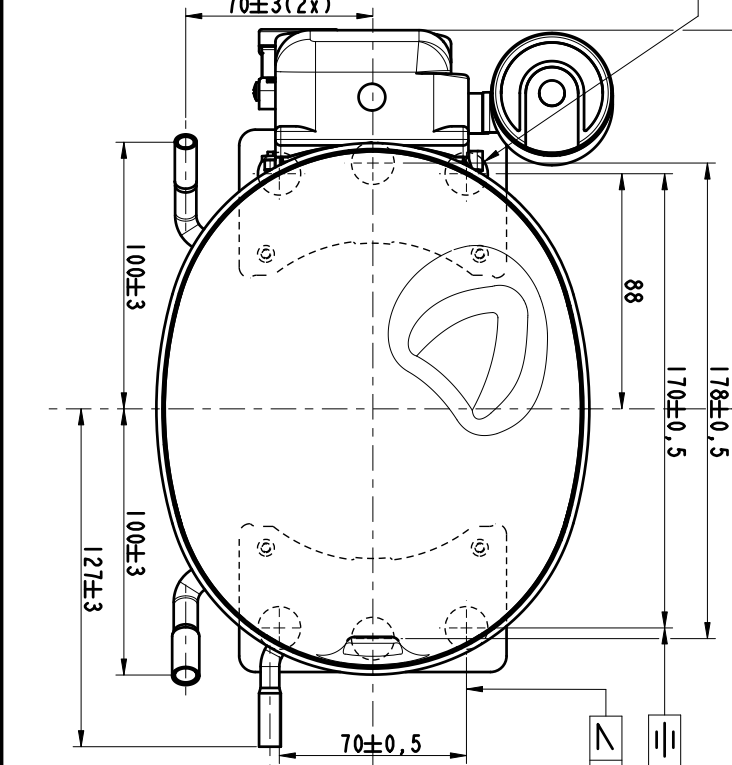

CODE :	MATERIAL :
APP. : VALENO P.	DRAWN : TONELLA M.
ECM : TDT 29225	03-07-2002
embraco VISTA ESTERNA "NE" EXTERNAL VIEW "NE" COMPRESSORS	
GEN. TOL. : --	ANG. TOL. : --
SCALE : 1:2	REPLACE : --
No. : 1.960.798	---

MODEL	KK	K	A	B	C	SHELL TYPE	MODELS
206	127	115	6.1-6.2 X 20 DEEP	8.1-8.2 X 20 DEEP	6.1-6.2 X 20 DEEP	953.51	NE2134GK
200	127	115	6.1-6.2 X 20 DEEP	8.1-8.2 X 20 DEEP	6.1-6.2 X 20 DEEP	952.51	NE6181GK
188	115	115	6.1-6.2 X 20 DEEP	8.1-8.2 X 20 DEEP	6.1-6.2 X 20 DEEP	261.50 261.51 951.51	NE5160Z NE5170Z NE6170Z NE5187Z NE6187Z NE2125E NE6210E NE2125GK NE6210GK