



Model: NT2192GK
Code: 923EA04

embraco POWER IN.
CHANGE ON

Type:	On-off
Voltage [V] / Frequency [Hz] / Phases	220-240 V 50 Hz 1 ~
Refrigerant:	R-404A
Application:	LBP

Motor type:	
Starting torque:	HST
HP:	1+
Displacement:	22.37 cm ³

OPERATING CONDITION : ASHRAE LBP 32

Evaporation Temp.	-23.3 °C	Return Temp.	32.2 °C	Superheating	55.5 K
Condensing Temp.	54.4 °C	Liquid Temp.	32.2 °C	Subcooling	22.2 K

Cooling capacity	Power consumption	Mass flow rate	Efficiency
1,069.52 W	737.44 W	24.85 kg/h	1.45 W/W

APPLICATION

Evaporating temperature range:	-40 to -10 °C	Cooling type:	Fan Cooling
Permanent operating temperature (peak) :	55 (60) °C	Air Flow	--
Expansion device:	Capillary tube or Expansion valve	Maximum motor temperature:	130 °C

ELECTRICAL DATA

Start winding resistance at 25°C (77°F):	8.4 Ω +/- 8%	Run winding resistance at 25°C (77°F):	1.9 Ω +/- 8%
FLA - full load amperage L/MBP [A] 50 Hz / 60 Hz:	- / -	LRA (A) 50 Hz / 60 Hz:	35 / -
		FLA - full load amperage HBP [A] 50 Hz / 60 Hz:	- / -

MECHANICAL DATA

Bore:	36.99 mm	Stroke:	10.42 mm
		Displacement:	22.37 cm ³

OTHER INFORMATION

Weight:	17.5 kg	Oil charge:	450 ml
Lubricant type:	Polyolester ISO22	Nitrogen charge:	Yes

EXTERNAL SETTINGS

	Shape	Material	Diameter [mm]
-			
Suction connector	Vertical	Copper	9.60
Discharge connector	Vertical	Copper	6.42
Process connector	Vertical	Copper	6.42
Base plate:	Universal	Tray holder:	No

PERFORMANCES AT STANDARD CHECK-POINTS

Checkpoint	Cooling capacity	Power consumption	Gas flow rate	Cooling Efficiency	Heating capacity +/-	Heating Efficiency
	+/-5% W	+/-5% W	+/-5% kg/h	+/- 7% W/W	5% * W	+/- 7% W/W
EN12900 LBP	568.36	526.02	15.39	1.08	838.79	1.59
EN12900 MBP	1,731.20	976.76	51.99	1.77	2,261.39	2.32
EN12900HO	725.58	702.76	22.61	1.03	1,117.50	1.59

* Calculations performed considering isentropic compression and a housing loss of 10%. This is an estimated heat amount discarded in the discharge pipe and the condenser combined.

CONDENSING TEMP. 35 °C**(SUBCOOLING : 22.2 K, RETURN TEMP.: 32 °C)**

Evaporating temperature °C	Cooling capacity	Power consumption	Gas flow rate	Cooling Efficiency	Heating capacity +/-	Heating Efficiency
	+/-5%	+/-5%	+/-5%	+/- 7%	5% *	+/- 7%
	W	W	kg/h	W/W	W	W/W
-40.00	593.95	435.25	11.49	1.36	817.25	1.88
-35.00	796.09	503.91	15.44	1.58	1,064.85	2.11
-30.00	1,042.59	575.69	20.29	1.81	1,357.26	2.36
-25.00	1,340.35	647.75	26.17	2.07	1,700.12	2.62
-20.00	1,696.10	716.18	33.26	2.37	2,098.40	2.93
-15.00	2,116.99	776.30	41.73	2.73	2,557.23	3.29
-10.00	2,610.92	822.93	51.77	3.17	3,082.35	3.75

CONDENSING TEMP. 45 °C**(SUBCOOLING : 22.2 K, RETURN TEMP.: 32 °C)**

Evaporating temperature °C	Cooling capacity	Power consumption	Gas flow rate	Cooling Efficiency	Heating capacity +/-	Heating Efficiency
	+/-5%	+/-5%	+/-5%	+/- 7%	5% *	+/- 7%
	W	W	kg/h	W/W	W	W/W
-40.00	487.21	431.80	10.24	1.13	706.72	1.64
-35.00	669.28	511.78	14.11	1.31	942.30	1.84
-30.00	888.84	596.49	18.80	1.49	1,216.07	2.04
-25.00	1,154.16	684.77	24.51	1.69	1,536.21	2.24
-20.00	1,472.32	773.59	31.41	1.90	1,908.50	2.47
-15.00	1,850.14	858.65	39.68	2.15	2,338.03	2.72
-10.00	2,294.87	934.81	49.54	2.45	2,829.97	3.03

CONDENSING TEMP. 55 °C**(SUBCOOLING : 22.2 K, RETURN TEMP.: 32 °C)**

Evaporating temperature °C	Cooling capacity	Power consumption	Gas flow rate	Cooling Efficiency	Heating capacity +/-	Heating Efficiency
	+/-5%	+/-5%	+/-5%	+/- 7%	5% *	+/- 7%
	W	W	kg/h	W/W	W	W/W
-40.00	370.29	407.66	8.56	0.91	570.01	1.40
-35.00	539.08	502.60	12.50	1.07	804.02	1.60
-30.00	734.33	600.15	17.09	1.22	1,062.45	1.77
-25.00	967.52	702.76	22.61	1.38	1,359.44	1.93
-20.00	1,246.96	809.26	29.29	1.54	1,703.36	2.10
-15.00	1,579.73	916.37	37.33	1.72	2,100.08	2.29
-10.00	1,972.63	1,019.41	46.94	1.94	2,554.61	2.51

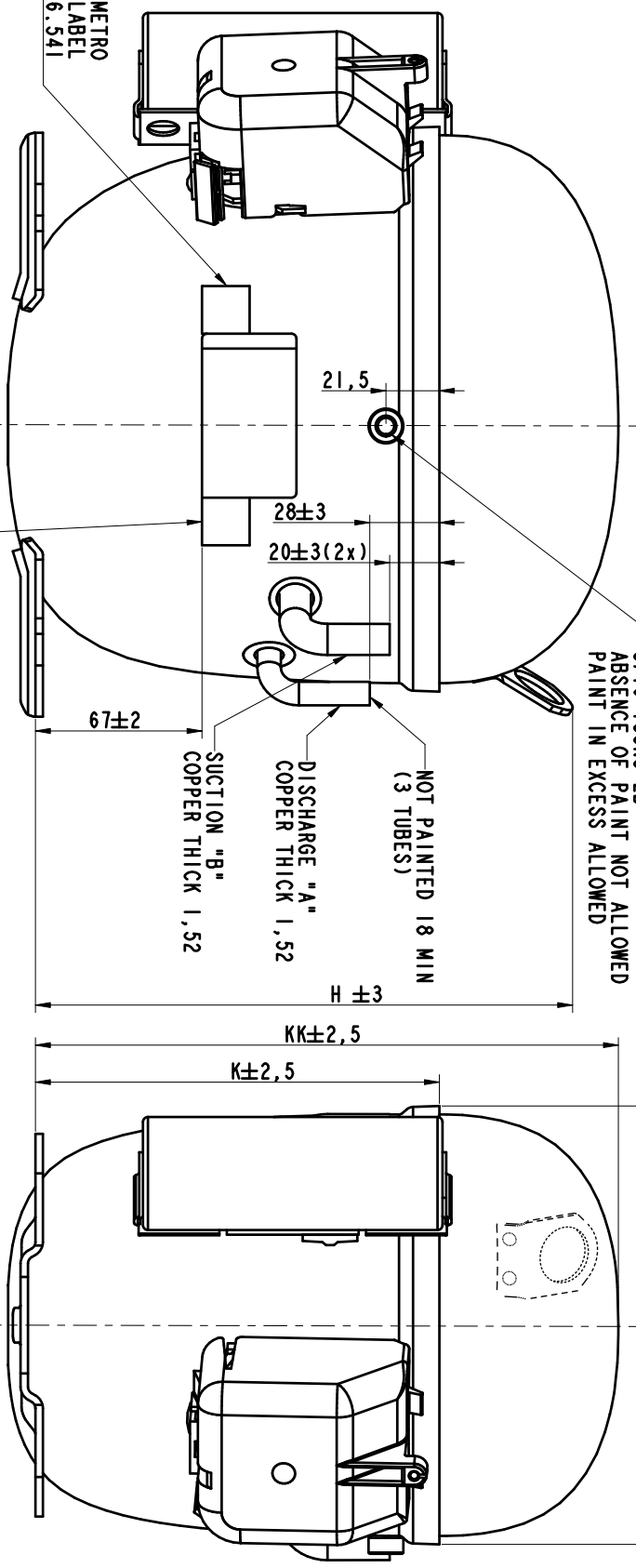

ECM	REVISION	LO	BY	APP	DATE	
-	ADDED HANGER TAB	-	-	-	21.11.2005	
507590	1	RELEASED	PV	VP	16.03.2006	
513311	2	ADDED SHELL 842.04 ADDED NT2160U, NT2170U	TAB	AP	RR	12.03.2009
517385	3	PROCESS TUBE CHANGED	TAB	LF	JK	13.05.2011
305537	4	ADDED NOTE ABOUT IMMETRO LABEL	C6	DG	MG	31.07.2013
34220	5	ADDED MODEL NT2170V	TAB	LF	MG	06.06.2014

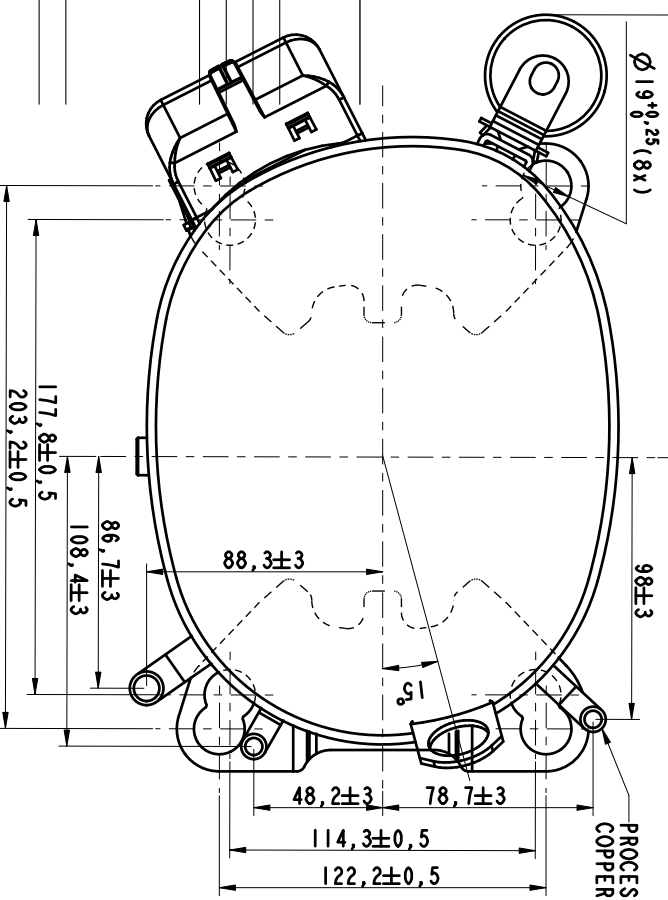

234	162.5	216	6.42-6.5 X23 DEEP	9.6-9.67 X22 DEEP	6.42-6.5 X23 DEEP	923.04	NT21926K NT21806K
220	148.5	202				922.04	NT21686K NT62226K NT21786K NT62126K NT62176K
KK	K	H	A	B	C	SHELLTYPE	MODELS
MATERIAL :							
CODE :							
DRAWN : P. VALERO 01.04.2005							
APP. : VALERO 01.04.2005							
ECM :							
NAME				NAME			
embraco				NT EXTERNAL VIEW CSIR PIN FUSITE			
GEN. TOL. :				GEN. TOL. :			
ANG. TOL. :				ANG. TOL. :			
SCALE :				SCALE :			
REPLACE				REPLACE			
No.				No.			
1.960.883				1.960.883			

THIS MATERIAL IS SPECIFICALLY AND EXCLUSIVELY FOR EMBRACO EQUIPMENT AND ANY USE OUTSIDE OF THIS SCOPE IS PROHIBITED ON PAIN OF PERSECUTION.