



Model: NT6217GK
Code: 922AA04

embraco POWER IN.
CHANGE ON

Type:	On-off
Voltage [V] / Frequency [Hz] / Phases	220-240 V 50 Hz 1 ~
Refrigerant:	R-404A
Application:	MBP

Motor type:	
Starting torque:	HST
HP:	3/4
Displacement:	12.55 cm ³

OPERATING CONDITION : ARI HBP

Evaporation Temp.	7.2 °C	Return Temp.	18.3 °C	Superheating	11.1 K
Condensing Temp.	54.4 °C	Liquid Temp.	54.4 °C	Subcooling	0.0 K

Cooling capacity	Power consumption	Mass flow rate	Efficiency
1,487.74 W	2,170.38 W	56.42 kg/h	0.69 W/W

APPLICATION

Evaporating temperature range:	-20 to 10 °C	Cooling type:	Fan Cooling
Permanent operating temperature (peak) :	55 (60) °C	Air Flow	--
Expansion device:	Capillary tube or Expansion valve	Maximum motor temperature:	130 °C

ELECTRICAL DATA

Start winding resistance at 25°C (77°F):	13.1 Ω +/- 8%	Run winding resistance at 25°C (77°F):	3.1 Ω +/- 8%
FLA - full load amperage L/MBP [A] 50 Hz / 60 Hz:	- / -	LRA (A) 50 Hz / 60 Hz:	22 / -
		FLA - full load amperage HBP [A] 50 Hz / 60 Hz:	- / -

MECHANICAL DATA

Bore:	31.74 mm	Stroke:	7.94 mm
		Displacement:	12.55 cm ³

OTHER INFORMATION

Weight:	16.7 kg	Oil charge:	450 ml
Lubricant type:	Polyolester ISO22	Nitrogen charge:	Yes

EXTERNAL SETTINGS

-	Shape	Material	Diameter [mm]
Suction connector	Vertical	Copper	9.60
Discharge connector	Vertical	Copper	6.42
Process connector	Vertical	Copper	6.42
Base plate:	Universal	Tray holder:	No

PERFORMANCES AT STANDARD CHECK-POINTS

Checkpoint	Cooling capacity	Power consumption	Gas flow rate	Cooling Efficiency	Heating capacity +/-	Heating Efficiency
	+/-5%	+/-5%	+/-5%	+/- 7%	5% *	+/- 7%
	W	W	kg/h	W/W	W	W/W
EN12900 HBP	1,533.97	1,933.95	52.16	0.79	1,902.87	0.98
EN12900 MBP	943.46	1,377.80	28.33	0.68	1,232.40	0.89

* Calculations performed considering isentropic compression and a housing loss of 10%. This is an estimated heat amount discarded in the discharge pipe and the condenser combined.

CONDENSING TEMP. 35 °C**(SUBCOOLING : 0 K, RETURN TEMP.: 32 °C)**

Evaporating temperature °C	Cooling capacity	Power consumption	Gas flow rate	Cooling Efficiency	Heating capacity +/-	Heating Efficiency
	+/-5% W	+/-5% W	+/-5% kg/h	+/- 7% W/W	5% * W	+/- 7% W/W
-20.00	754.19	937.84	18.13	0.80	973.45	1.04
-15.00	942.76	1,044.11	22.80	0.90	1,183.34	1.13
-10.00	1,164.23	1,137.50	28.36	1.02	1,422.54	1.25
-5.00	1,422.34	1,210.56	34.95	1.17	1,693.44	1.40
0.00	1,721.39	1,255.32	42.72	1.37	1,998.93	1.59
5.00	2,066.49	1,263.45	51.89	1.64	2,342.62	1.85
10.00	2,463.84	1,226.48	62.74	2.01	2,729.10	2.23

CONDENSING TEMP. 45 °C**(SUBCOOLING : 0 K, RETURN TEMP.: 32 °C)**

Evaporating temperature °C	Cooling capacity	Power consumption	Gas flow rate	Cooling Efficiency	Heating capacity +/-	Heating Efficiency
	+/-5% W	+/-5% W	+/-5% kg/h	+/- 7% W/W	5% * W	+/- 7% W/W
-20.00	629.94	1,025.35	17.04	0.61	866.65	0.85
-15.00	792.19	1,171.70	21.58	0.68	1,057.55	0.90
-10.00	983.52	1,314.85	27.01	0.75	1,275.33	0.97
-5.00	1,207.01	1,447.91	33.47	0.83	1,521.76	1.05
0.00	1,466.19	1,563.23	41.12	0.94	1,798.99	1.15
5.00	1,765.13	1,652.47	50.17	1.07	2,109.65	1.28
10.00	2,108.69	1,706.68	60.88	1.24	2,457.12	1.44

CONDENSING TEMP. 55 °C**(SUBCOOLING : 0 K, RETURN TEMP.: 32 °C)**

Evaporating temperature °C	Cooling capacity	Power consumption	Gas flow rate	Cooling Efficiency	Heating capacity +/-	Heating Efficiency
	+/-5% W	+/-5% W	+/-5% kg/h	+/- 7% W/W	5% * W	+/- 7% W/W
-20.00	504.82	1,079.38	15.84	0.47	751.61	0.70
-15.00	638.91	1,259.66	20.20	0.51	920.58	0.73
-10.00	797.68	1,446.65	25.47	0.55	1,113.42	0.77
-5.00	983.64	1,634.61	31.75	0.60	1,331.36	0.81
0.00	1,199.48	1,816.86	39.23	0.66	1,575.75	0.87
5.00	1,448.17	1,986.03	48.11	0.73	1,848.15	0.93
10.00	1,733.14	2,134.09	58.65	0.81	2,150.55	1.01

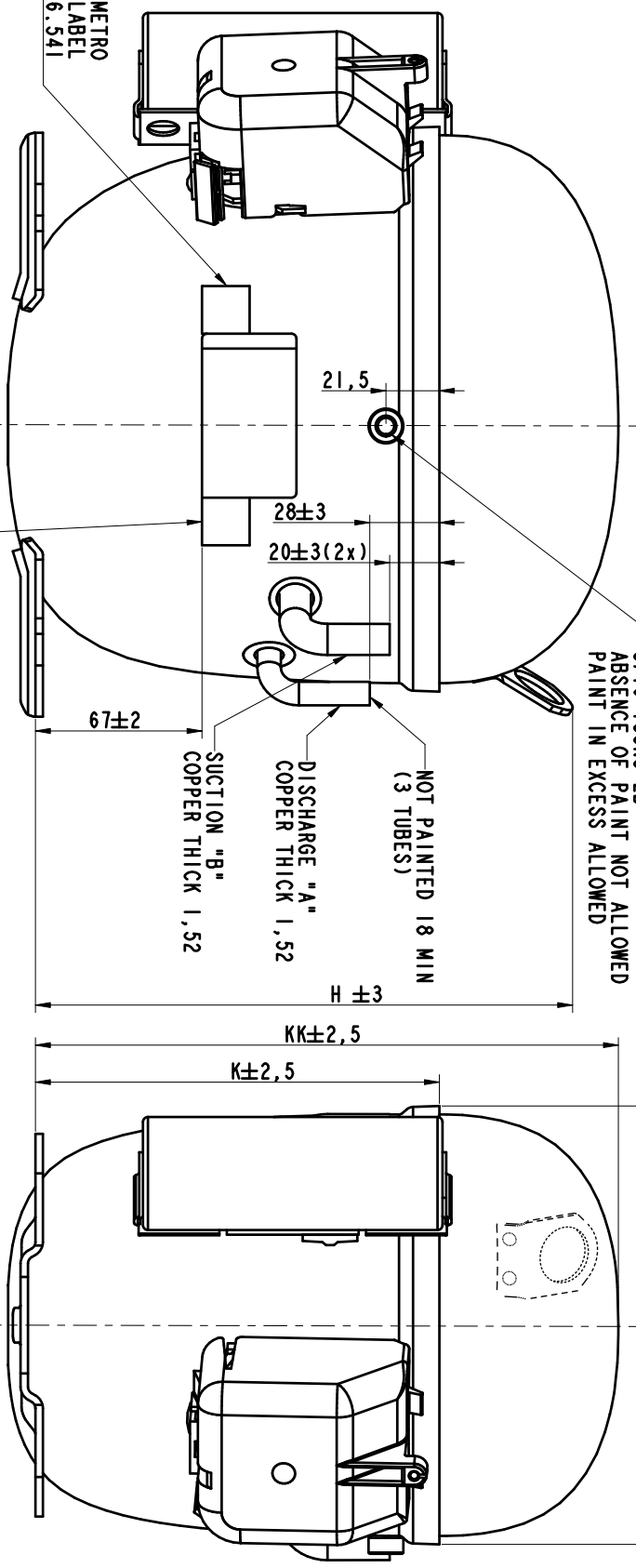

ECM	REVISION	LO	BY	APP	DATE	
-	ADDED HANGER TAB	-	-	-	21.11.2005	
507590	1	RELEASED	PV	VP	16.03.2006	
513311	2	ADDED SHELL 842.04 ADDED NT2160U, NT2170U	TAB	AP	RR	12.03.2009
517385	3	PROCESS TUBE CHANGED	TAB	LF	JK	13.05.2011
305537	4	ADDED NOTE ABOUT IMMETRO LABEL	C6	DG	MG	31.07.2013
34220	5	ADDED MODEL NT2170V	TAB	LF	MG	06.06.2014

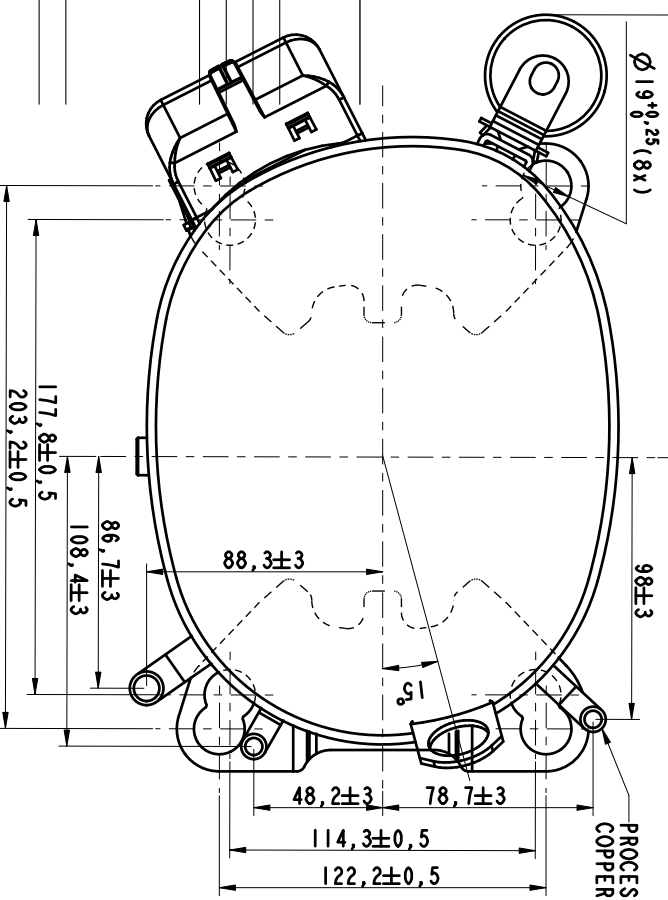

234	162.5	216	220	148.5	202	I.D. 6.42-6.5 X23 DEEP	I.D. 9.6-9.67 X22 DEEP	I.D. 6.42-6.5 X23 DEEP	923.04	NT21926K	NT21806K
KK	K	H	A	B	C	SHELLTYPE		842.04	922.04	NT21686K	NT21786K
										NT162226K	NT162176K
										NT2160U	NT2170U
										NT62170V	

MATERIAL :
CODE :
DRAWN : P. VALERO 01.04.2005
APP. : VALERO 01.04.2005
ECM :

NAME
embraco
NT EXTERNAL VIEW
CSIR PIN FUSITE

GEN. TOL. :
ANG. TOL. :
SCALE : 1:2
REPLACE
No. 1.960.883

THIS MATERIAL IS SPECIFICALLY AND EXCLUSIVELY FOR EMBRACO ENGINEERING AND ANY OTHER REUSE OR REPRODUCTION IS STRICTLY PROHIBITED ON PAIN OF LAW.