



Model: NT6224GK
Code: 922RA04

embraco POWER IN.
CHANGE ON

Type:	On-off
Voltage [V] / Frequency [Hz] / Phases	220-240 V 50 Hz 1 ~
Refrigerant:	R-404A
Application:	MBP

Motor type:	CSCR
Starting torque:	HST
HP:	1
Displacement:	20.44 cm ³

OPERATING CONDITION : ARI HBP

Evaporation Temp.	7.2 °C	Return Temp.	18.3 °C	Superheating	11.1 K
Condensing Temp.	54.4 °C	Liquid Temp.	54.4 °C	Subcooling	0.0 K

Cooling capacity	Power consumption	Mass flow rate	Efficiency
2,460.97 W	1,367.80 W	93.34 kg/h	1.80 W/W

APPLICATION

Evaporating temperature range:	-20 to 10 °C	Cooling type:	Fan Cooling
Permanent operating temperature (peak) :	55 (60) °C	Air Flow	--
Expansion device:	Capillary tube or Expansion valve	Maximum motor temperature:	130 °C

ELECTRICAL DATA

Start winding resistance at 25°C (77°F):	6.49 Ω +/- 8%	Run winding resistance at 25°C (77°F):	1.69 Ω +/- 8%
FLA - full load amperage L/MBP [A] 50 Hz / 60 Hz:	- / -	LRA (A) 50 Hz / 60 Hz:	29 / -
		FLA - full load amperage HBP [A] 50 Hz / 60 Hz:	- / -

MECHANICAL DATA

Bore:	36.99 mm	Stroke:	9.52 mm
		Displacement:	20.44 cm ³

OTHER INFORMATION

Weight:	17.2 kg	Oil charge:	450 ml
Lubricant type:	Polyolester ISO22	Nitrogen charge:	Yes

EXTERNAL SETTINGS

-	Shape	Material	Diameter [mm]
Suction connector	Vertical	Copper	9.60
Discharge connector	Vertical	Copper	6.42
Process connector	Vertical	Copper	6.42
Base plate:	Universal	Tray holder:	No

PERFORMANCES AT STANDARD CHECK-POINTS

Checkpoint	Cooling capacity	Power consumption	Gas flow rate	Cooling Efficiency	Heating capacity +/-	Heating Efficiency
	+/-5% W	+/-5% W	+/-5% kg/h	+/- 7% W/W	5%* W	+/- 7% W/W
EN12900 HBP	2,540.85	1,270.30	86.39	2.00	3,151.89	2.48
EN12900 MBP	1,563.08	967.99	46.94	1.61	2,041.79	2.11

* Calculations performed considering isentropic compression and a housing loss of 10%. This is an estimated heat amount discarded in the discharge pipe and the condenser combined.

CONDENSING TEMP. 35 °C**(SUBCOOLING : 0 K, RETURN TEMP.: 32 °C)**

Evaporating temperature °C	Cooling capacity	Power consumption	Gas flow rate	Cooling Efficiency	Heating capacity +/-	Heating Efficiency
	+/-5% W	+/-5% W	+/-5% kg/h	+/- 7% W/W	5% * W	+/- 7% W/W
-20.00	1,252.95	752.57	30.12	1.66	1,617.22	2.15
-15.00	1,565.58	816.34	37.87	1.92	1,965.10	2.41
-10.00	1,933.20	878.10	47.10	2.20	2,362.12	2.69
-5.00	2,362.72	934.55	58.05	2.53	2,813.06	3.01
0.00	2,861.73	981.52	71.02	2.92	3,323.13	3.39
5.00	3,438.97	1,013.83	86.36	3.39	3,898.50	3.85
10.00	4,104.95	1,025.02	104.52	4.00	4,546.90	4.44

CONDENSING TEMP. 45 °C**(SUBCOOLING : 0 K, RETURN TEMP.: 32 °C)**

Evaporating temperature °C	Cooling capacity	Power consumption	Gas flow rate	Cooling Efficiency	Heating capacity +/-	Heating Efficiency
	+/-5% W	+/-5% W	+/-5% kg/h	+/- 7% W/W	5% * W	+/- 7% W/W
-20.00	1,043.42	778.35	28.23	1.34	1,435.50	1.84
-15.00	1,313.81	856.95	35.79	1.53	1,753.89	2.05
-10.00	1,630.96	936.75	44.80	1.74	2,114.87	2.26
-5.00	2,001.53	1,015.56	55.50	1.97	2,523.46	2.48
0.00	2,432.20	1,090.30	68.21	2.23	2,984.27	2.74
5.00	2,930.25	1,157.07	83.28	2.53	3,502.19	3.03
10.00	3,504.08	1,211.11	101.17	2.89	4,083.06	3.37

CONDENSING TEMP. 55 °C**(SUBCOOLING : 0 K, RETURN TEMP.: 32 °C)**

Evaporating temperature °C	Cooling capacity	Power consumption	Gas flow rate	Cooling Efficiency	Heating capacity +/-	Heating Efficiency
	+/-5% W	+/-5% W	+/-5% kg/h	+/- 7% W/W	5% * W	+/- 7% W/W
-20.00	825.14	785.77	25.89	1.05	1,228.54	1.56
-15.00	1,054.28	878.91	33.34	1.20	1,519.07	1.73
-10.00	1,319.49	974.62	42.12	1.35	1,841.77	1.89
-5.00	1,627.78	1,072.38	52.55	1.52	2,203.21	2.05
0.00	1,985.27	1,170.32	64.94	1.70	2,608.04	2.23
5.00	2,397.86	1,265.67	79.66	1.89	3,060.16	2.42
10.00	2,871.82	1,354.97	97.19	2.12	3,563.47	2.63

ELECTRICAL ACCESSORIES

Kit:	1
Starter device:	VOLTAGE RELAY
Engineering code:	3ARR3B6AV3
Run capacitor:	25
Starting capacitor:	88-108

Thermal protector: T0590/G9**Institutes approved for this electric kit:**

If purchased without electricals consult Embraco to verify the supplier of electricals approved for this compressor

MECHANICAL ACCESSORIES**Rubber damper:** Yes**Metal bushing:** Optional

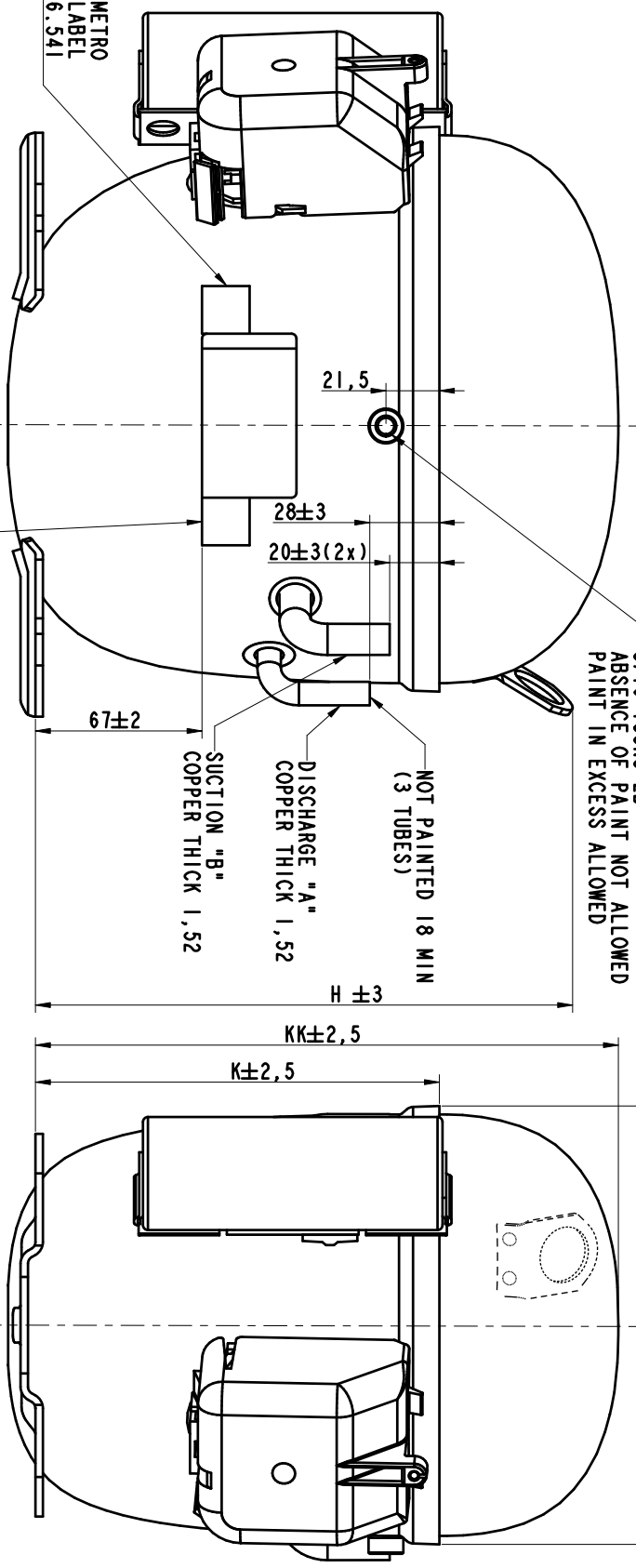

PLACE FOR IMMETRO
COMPRESSOR LABEL
2.216.541

REFRIGERANT LABEL

PROCESS "C"
COPPER THICK 1,52

ECM	REVISION	LO	BY	APP	DATE	
-	ADDED HANGER TAB	-	-	-	21.11.2005	
507590	1	RELEASED	PV	VP	16.03.2006	
513311	2	ADDED SHELL 842.04 ADDED NT2160U, NT2170U	TAB	AP	RR	12.03.2009
517385	3	PROCESS TUBE CHANGED	TAB	LF	JK	13.05.2011
30557	4	ADDED NOTE ABOUT IMMETRO LABEL	C6	DG	MG	31.07.2013
34220	5	ADDED MODEL NT2170V	TAB	LF	MG	06.06.2014

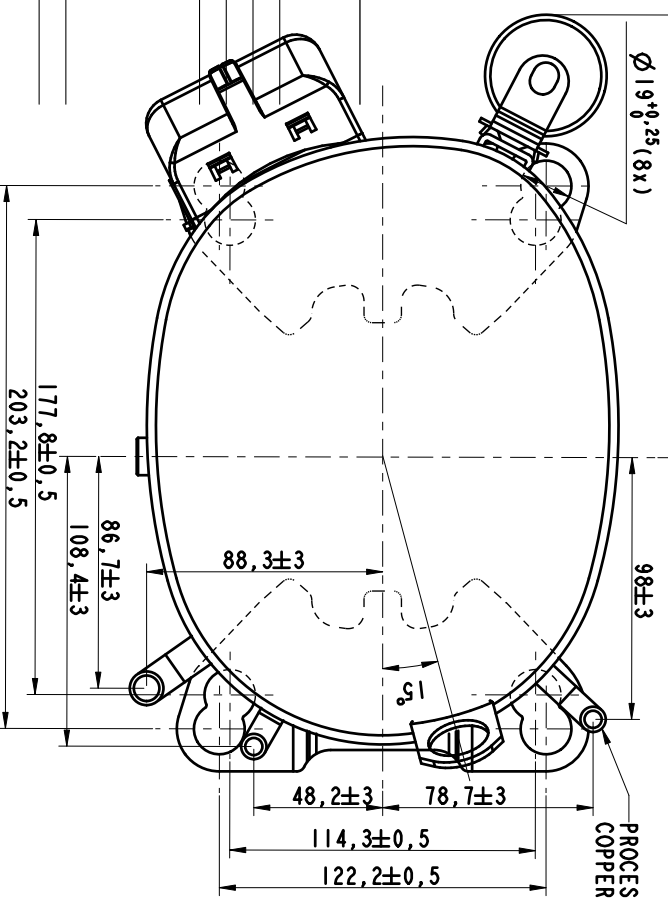

234	162.5	216				923.04	NT21926K	NT21806K
220	148.5	202				922.04	NT21686K	NT21786K
						842.04	NT162226K	NT162176K
							NT2160U	NT2170U
							NT62170V	

KK	K	H	A	B	C	SHELLTYPE	MODELS

MATERIAL :		NAME	
CODE :		NT EXTERNAL VIEW	
DRAWN : P. VALERO 01.04.2005		CSIR PIN FUSITE	
APP. : VALERO 01.04.2005			
ECM :		THIS MATERIAL IS SPECIFICALLY AND EXCLUSIVELY TO EMBRACO ENGINEERING AND ANY USE OF IT OUTSIDE OF THE COMPANY IS PROHIBITED BY LAW.	
		GEN. TOL. :	
		ANG. TOL. :	
		SCALE : 1:2	
		REPLACE	
		No. 1.960.883	